



# NAVOTTHANAM

प्रेम ही संवेदना है।



 [info@navotthanam.org.in](mailto:info@navotthanam.org.in)

 [www.navotthanam.org.in](http://www.navotthanam.org.in)

 +91 7987364219 / +91 74772 80103

 Place Near phoenix poultry village Dunda, Khandiya  
tiraha, Barkheda Tehsil Kundam, Dist. Jabalpur M.P 483110

# ABOUT US

---

NAVOTTHANAM, a wholehearted noble initiative by SHREYANVI WELFARE SOCIETY JABALPUR, is dedicated to serving individuals with special needs, especially those with autism. Our autism institute stands as a ray of hope for differently abled children and their parents, providing essential guidance, consultation, scientific therapies to enhance their quality of life and promote their overall well-being.

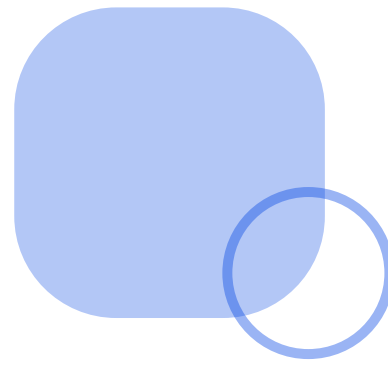

**NAVOTTHANAM**  
प्रेम ही संवेदना है।

## What we do

01

Providing residential care and education for autistic children.

02

Health care and general upkeep of specially challenged children.

03

General upkeep and all types of therapies needed by specially challenged persons.

04

School education, higher education including Engineering, Medical and Professional courses.

# OUR PURPOSE

---

- Providing residential care and education for autistic children.
- Health care and general upkeep of specially challenged children.
- General upkeep and all types of therapies needed by specially challenged persons.
- School education, higher education including Engineering, Medical and Professional courses.

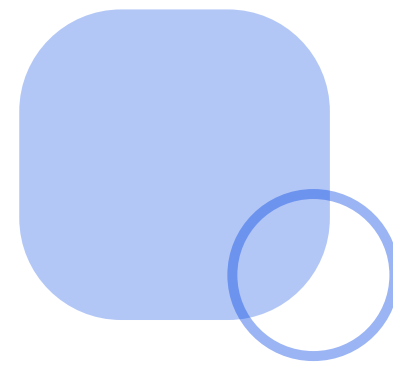

**NAVOTTHANAM**  
प्रेम ही संवेदना है।

01

## Our Mission

To raise awareness and mainstream the children with special needs into society, and to provide all facilities required to enhance their development and self-reliance.

02

## Our Vision

We envision a society where children with disabilities can thrive, be valued, and empowered to make meaningful contributions to their communities.

03

## Our Objectives

To provide total support, including education, therapy, vocational training, and community engagement, to improve their holistic well-being.

# PRESIDENT MESSAGE

---

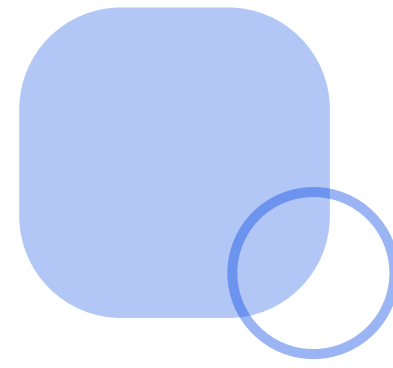

**NAVOTTHANAM**  
प्रेम ही संवेदना है।

As President of SHREYANVI WELFARE SOCIETY, I am deeply honored to lead our initiative, नवोत्थानम्. Here, our mission is to empower children with special needs, particularly those with autism, through comprehensive support and compassionate care. We aim to offer all needed therapies, residential care, medical and educational facilities, strive to enhance their quality of life and promote independence. Together, we can create a more inclusive and equitable society where every child is valued and given the opportunity to thrive. Thank you for joining us in this vital mission.

-

**Seema Singh**

President, Navotthanam

# BOARD MEMBERS

---



**NAVOTTHANAM**  
प्रेम ही संवेदना है।



**Seema Singh**  
President

Seema Singh, President of Navotthanam, is dedicatedly working with Navotthanam since it was incorporated as a welfare organisation.



**Sarika Pandey**  
Secretary

Previously a financial advisor in the finance and insurance sector, she is now a homemaker and dedicating her skills to Navotthanam for societal betterment.



**Alka Kaushik**  
Treasurer

Former financial advisor in the finance and insurance industry, now a homemaker, she will devote her time to Navotthanam, leveraging her skills to contribute to societal improvement.

# ADVISORY BOARD

---



**NAVOTTHANAM**  
प्रेम ही संवेदना है।



**Vivek Tankha**  
Member of Rajya Sabha, Delhi

Congress leader Vivek Tankha is not only a renowned lawyer but also a commendable social activist. He has always drawn his sword for important social issues like women empowerment, safety, health, and hygiene.

He is a hero in the true sense as he works towards providing better things to the underprivileged. On the other hand, he strives day in and day out to build better infrastructure in Madhya Pradesh. His social work is not limited to the state, back in 2005 when Uri experienced their worst earthquake, Mr. Tankha was there to support them with all his resources and emotions.



**Shekhar Mehta**  
Ex-Rotary International President of  
Kolkata

Shekhar Mehta is only the 4th Indian in 115 years to be nominated as the President of Rotary International for the year 2021-22. Shekhar Mehta was born in 1959 in Kolkata India. A keen academician, he graduated from St. Xavier's College, and has the unique combination of Masters in Commerce, a qualified Chartered Accountant, Cost Accountant and Company Secretary.

# ADVISORY BOARD

---



**Akhil Mishra**

Rotary District Governor, Jabalpur

Akhil Mishra, born on January 19, 1971, is a successful entrepreneur and social leader. Starting from humble beginnings, he built a thriving business in consumer durables, education, and construction. He has held key positions in the Rotary Club and other organizations, earning numerous accolades, including a Guinness World Record and government honors for his community service and leadership.



**Santosh Shrivastava**

Counsellor

Santosh Shrivastava, a Civil Engineer with 33 years at MPSEB/MP Power Generating Co., is dedicated to social service, especially aiding the needy. His work with Virat Hospice and Maharshi Babra School provides free support to cancer patients and students. Even in retirement, his commitment to societal welfare remains strong, making a significant impact through various social initiatives.



**NAVOTTHANAM**  
प्रेम ही संवेदना है।

# ADVISORY BOARD

---



**Anurag Shrikhande**  
Engineer & Architect

With a profound dedication to excellence and a career spanning over 25 years, Er. Anurag Shrikhande stands as the Engineer Director of Shrikhande Designs Pvt. Ltd. (SDPL). SDPL, an acronym for Shrikhande Designs Private Limited, is a true embodiment of his commitment to delivering unparalleled architectural and civil engineering services. Anurag's philosophy echoes through our company, as he believes, "A good director makes a playground and allows you to play."

Experience: 25+ Years

Experience: Boasting a remarkable journey of more than a quarter-century, Er. Anurag Shrikhande's expertise and innovative approach have become the cornerstone of our company's success. His keen engineering insights and dynamic leadership have transformed SDPL into a hub of creativity and technical excellence.

[www.sdplweb.com](http://www.sdplweb.com)



**NAVOTTHANAM**  
प्रेम ही संवेदना है।

# OUR DOCTORS

---



**Dr. Rajesh Dhirawani**

- BSc.,BDS,MDS(BOM), FIAOS(USA),FAAOMS(USA),FDS RCPS(Glasgow ) MNAMS Managing Director , Jabalpur Hospital & Research Centre, Jabalpur
- Director, HITKARINI Dental College & Hospital
- Chairman, Jabalpur Institute of Health Sciences
- Past secretary General & Past President, Association of Oral & Maxillofacial Surgeons of India
- Conferred Diplomat of American Board of Maxillofacial Surgery
- Diplomat of Indian Board of Maxillofacial Surgery
- Awarded President of India award in 2009 for exemplary service in treatment and awareness programs of Oral Cancers in India
- Member, Executive council , M. P. Medical Science University
- Co-Ordinator in India for Health Volunteers Overseas USA
- National Co-Ordinator, Indian Academy of Maxillofacial surgery
- Founder Member,Asian Association of Maxillofacial surgeons
- Councillor, International Association of Maxillofacial surgeons
- Visiting Professor, University of Maryland, Miami and Louisiana USA
- Past President & Asstt. Governor, Rotary Club of Jabalpur
- Patron, Mahakaushal Deaf & Dumb association
- Trustee, Justice Tankha Memorial Institute for spastic & Handicap Children
- President, AIM FOR SEVA, Mahakaushal
- President, Arogya Bharti, Mahakaushal Prant



**NAVOTTHANAM**  
प्रेम ही संवेदना है।

# OUR DOCTORS

---



**Dr. Swaraj Naik - M.D OBGY FICOG**  
**Director-Consultant Naik Multispecialty Hospital , Jabalpur**

- Senior Consultant at Naik Multispecialty Hospital Jabalpur practicing Obstetrics and Gynecology since 1987
- Former President Jabalpur Menopause Society 2019-2021
- Former President Jabalpur Obstetrics & Gynecology Society 2010-2012
- Co-Ordinator Adolescent Committee, Jabalpur chapter 2009
- Vice-President Friends of Tribal Society (FTS) Jabalpur
- Started FETUS DAY in Jabalpur OBGY Society & FOGSI National Curriculum
- Life Member Indian Medical Association (IMA)
- Life Member Indian Menopause society (IMS)
- Awarded with President Rotating Trophy, FOGSI 2011
- Special Interest: High-risk pregnancy, menopause and General Obstetrics
- Actively participated in Internationals and National Conferences



**NAVOTTHANAM**  
प्रेम ही संवेदना है।

# WHAT IS AUTISM

---

Autism spectrum disorder (ASD), widely known as Autism, refers to a challenging, complicated, lifelong condition that includes neurological and developmental problems that affect communication and behavior.

## PREVALENCE:

According to the report of WHO (World Health Organisation) Autism affects 1 in 100 children worldwide.

## CHARACTERISTICS:

Difficulty in communication and social interaction

Repetitive behaviors or routines

Sensory sensitivities (light, sound, texture)

## PROBLEMS FACED BY CHILDREN

### Communication Complexities:

- Difficulty in verbal and non-verbal communication
- Delayed speech or lack of speech

### Difficulties during Social Interaction

- Struggles with understanding social cues
- Difficulty forming relationships with peers

### Communication Complexities:

Over or under-reactivity to sensory inputs

### Difficulties during Social Interaction

- Struggles with understanding social cues
- Difficulty forming relationships with peers

### Sensory Sensitivities:

Over or under-reactivity to sensory inputs

## PROBLEMS FACED BY PARENTS

### Mental and Emotional Stress:

- Feelings of isolation, stress, or helplessness
- Anxiety about their child's future and development

### Financial Burden:

- High costs of therapy, medical care, and specialized education
- Reduced income if a parent needs to stay home full-time

### Lack of Awareness and Support:

- Difficulty finding resources or support networks
- Social stigma or lack of understanding from others

### Time Management:

- Balancing care with other responsibilities (work, other children)

# OUR SERVICE

---

- Residential Services
- Day Boarding Services
- Special Education
- Different Therapy
- Regular Medical Check-up
- Recreational and Sports Activities
- Counselling Services



# NAVOTTHANAM'S SOLUTION

## RESIDENTIAL SERVICES FOR CHILDREN

### **Comprehensive Care:**

- 24/7 residential care by trained male and female staff.

### **Educational Support**

- Special Education
- NIOS Board Exam Preparation

### **Medical Care:**

- On-site Emergency Medical Center & Advanced Emergency Services
- Therapies: Occupational Therapy, Applied Behavior Analysis (ABA) therapy, Color therapy, Speech therapy, Hydro therapy, and more.
- Creative Expression(Music Classes).
- Spiritual and Contemplative Spaces: An Open Air theater, Prayer Centre, and Meditation center offer opportunities for spiritual exploration and relaxation.

### **Recreational Activities:**

- Large Playground
- Indoor Games Facilities: Badminton, table tennis, chess, carrom, and other indoor games are available.
- Expert Guidance

### **Family Accommodation:**

- Guest Rooms with Kitchen

### **Convenient Amenities:**

- Grocery Stores, Bakery and Fast Food Stalls



We are committed to providing a supportive and enriching environment where children with autism can thrive. Contact us today to learn more about our programs and facilities.

# NAVOTTHANAM'S SOLUTION

## FOR PARENTS:

**Key features of our residential services for parents include:**

**Proximity to Children:** Parents have the option to stay in comfortable quarters located within the same premises as their children. This ensures they can be nearby and participate actively in their child's daily life and care.

**Family Quarters:** Our facility includes well-appointed family quarters that provide a comfortable living space for parents. These quarters are designed to meet the needs of families, offering a homely environment where parents can relax and feel at ease.

**Supportive Community:** Living within our community allows parents to connect with other families, share experiences, and build a supportive network. This communal environment fosters a sense of belonging and mutual support.

**Access to Amenities:** Parents staying on-site have access to all the amenities available at NAVOTTHANAM. This includes recreational spaces, dining facilities, and other communal areas designed to enhance the quality of life for both children and their families.



**At NAVOTTHANAM,** we understand the importance of family support and the peace of mind that comes from being close to your child, especially for parents of children with special needs. To accommodate this, we offer residential services for parents who wish to stay near their children within our premises.

# NAVOTTHANAM'S SOLUTION

## FOR PARENTS:

**Participation in Programs:** Parents can be more involved in their child's education and therapy sessions, gaining insights and learning strategies that they can apply at home. This involvement is crucial for reinforcing the progress made during therapies and educational activities.

By providing residential services for parents, we ensure that families can stay together and support each other, creating a cohesive and nurturing environment for their child's development. Our goal is to make

NAVOTTHANAM not just a place of care and education, but a true community where families feel welcome and supported.

**Note:** We have created a very good surrounding where each individual will get everything they need. Our facility is designed to offer a beautiful and nurturing community that ensures children receive all the benefits of a home environment along with the specialized care and education they need to thrive. Parents can rest assured that they are nearby and able to provide the emotional support their children need.



**At NAVOTTHANAM,** we understand the importance of family support and the peace of mind that comes from being close to your child, especially for parents of children with special needs. To accommodate this, we offer residential services for parents who wish to stay near their children within our premises.

# DAY BOARDING SERVICES

At NAVOTTHANAM, we offer comprehensive day scholar services for children with special needs, particularly those with autism. Our day scholar program is designed for students who can commute from their homes to our institute daily. The program runs from morning to evening and includes a variety of essential services to enhance the quality of life and well-being of our students.

## **Our services include:**

**Therapies:** We provide a range of scientific therapies tailored to the unique needs of each child. These therapies are aimed at improving cognitive, motor, and social skills.

**Education:** Our curriculum is aligned with the National Institute of Open Schooling (NIOS) standards, ensuring that students receive quality education. Dedicated teachers and resources are available to help students prepare for NIOS board exams.

**Exercise and Physical Activities:** Regular exercise and physical activities are an integral part of our program, promoting physical health and well-being.

**Guidance and Consultation:** We offer expert guidance and consultation to parents, helping them support their child's development effectively. Students return to their homes in the evening, allowing them to enjoy the comforts of home while benefiting from our specialized services during the day.



**NAVOTTHANAM**  
प्रेम ही संवेदना है।



# SPECIAL EDUCATION

We are passionately committed to empowering children with special needs through education, helping them lead fulfilling lives. Our focus is on offering comprehensive educational support and specialised training, ensuring that each child understands their unique needs and receives personalised guidance. Our dedicated team of highly qualified teachers and special educators works tirelessly to enhance concentration, improve self-esteem, and promote independence. We provide diverse programs that encourage creativity, socialisation, and discipline, tailored to each child's individual strengths and challenges. Our ultimate goal is to see every differently-abled child thrive with the love and support they deserve.



**NAVOTTHANAM**  
प्रेम ही संवेदना है।



# DIFFERENT THERAPY

नवोत्थानम् is a nurturing haven for specially-abled children, especially the ones with Autism Spectrum Disorder, dedicated to their integration into mainstream society and ensuring their overall development and well-being. We understand the profound impact of personalised therapy treatments required to meet each child's unique needs. Our therapies focus on enhancing the quality of life and enabling effective communication, addressing a range of challenges such as communication, cognitive, voice, and swallowing disorders, as well as autism and sensory processing issues. Through our compassionate and comprehensive therapy programs, we empower these children to reach their fullest potential and thrive.

## We Provide

- Occupational Therapy
- Speech Therapy
- Physio Therapy
- Remedial Therapy
- Behavioural Therapy
- ABA Therapy
- Music Therapy
- Yoga and Meditation
- Counselling
- Vocational Training



**NAVOTTHANAM**  
प्रेम ही संवेदना है।



# OTHER SERVICES

## **Recreational and Sports Activities-**

We at नवोत्थानम् organise a wide range of recreational and sports activities for individuals, emphasising the profound benefits they bring. Our facilities include a o pool spacious playground, a swimming pool, badminton courts, and dedicated training services. These activities provide a platform for creativity, talent, and fun, fostering social interaction, boosting self-confidence, and instilling a sense of achievement. They enhance mental health, reduce stress, improve mobility, physical fitness, and build confidence and independence. We strive to create a warm, inclusive environment that celebrates their unique abilities and encourages active participation, enriching their overall well-being with joy and support.

## **Recreational and Sports Activities-**

We at नवोत्थानम् organise a wide range of recreational and sports activities for individuals, emphasising the profound benefits they bring. Our facilities include a o pool spacious playground, a swimming pool, badminton courts, and dedicated training services. These activities provide a platform for creativity, talent, and fun, fostering social interaction, boosting self-confidence, and instilling a sense of achievement. They enhance mental health, reduce stress, improve mobility, physical fitness, and build confidence and independence. We strive to create a warm, inclusive environment that celebrates their unique abilities and encourages active participation, enriching their overall well-being with joy and support.

## **Counselling Services**

We also offer compassionate counselling services to these children and their parents, providing essential support and guidance. Our dedicated counsellors address the various challenges faced by both children and parents, helping parents tackle their children's unique challenges and assisting children in navigating emotional struggles. P focus on developing coping strategies and building resilience. Our heartfelt goal is to empower families to overcome obstacles, enhance their well-being, and thrive both academically and personally.

# OUR EVENTS

## Independence Day

Independence Day, celebrated on August 15th at नवोत्थानम्, marks India's freedom from British rule in 1947. We observe this day with patriotic fervor, including our president's flag hoisting and singing the national anthem. We organize cultural events where our special children participate and pay tribute to freedom fighters. Our goal is to educate these children about our nation's proud history and the significance of this day, offering a sense of patriotism and pride in their heritage.

## Republic Day

We commemorate Republic Day on January 26th, honouring the moment of the adoption of India's Constitution in 1950. On this day, all our members and special children gather at our organization premises. Our president and secretary hoist the national flag, and we celebrate by sharing sweets and delicious food with the children. Our aim is to make these children aware of the significance of this day, cultivating feelings of pride and understanding of our nation's history and values.

## Annual Gala

The Annual Gala is our signature fundraising event, bringing together supporters, partners, and beneficiaries for an evening of inspiration and celebration. The event features keynote speeches, live entertainment, auctions, and award presentations, highlighting our achievements and outlining future goals.



# OUR EVENTS

## **Volunteer Appreciation Day**

This event is dedicated to recognizing and appreciating the hard work and dedication of our volunteers. The day includes a series of activities such as award ceremonies, thank-you notes, and fun activities to show our gratitude.

### **Purpose**

- Recognizing volunteers' contributions
- Building team spirit
- Encouraging continued support

## **Community Awareness Campaign**

Our Community Awareness Campaign aims to educate the public about our cause through workshops, seminars, and street activities. This event helps in spreading knowledge, breaking stigmas, and recruiting new supporters.

### **Purpose**

- Raising awareness
- Educating the public
- Attracting new supporters



# NAVOTHANAM VILLA



# NAVOTHANAM- VILLA PLAN

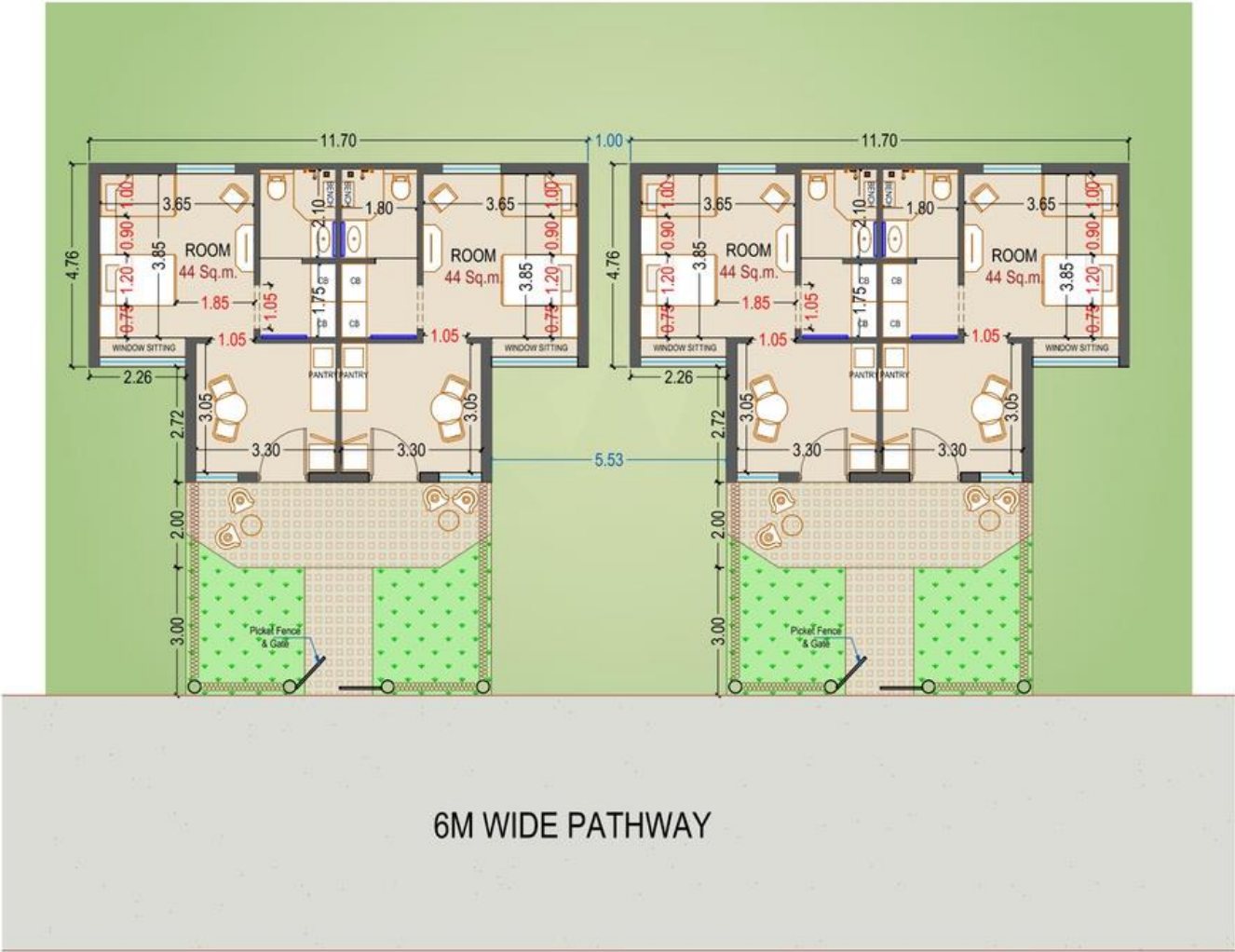

VILAS CONCEPT PLAN

S. NO.	DATE	REMARK	SHEET TITLE -
01.	08-08-2024	PDF	VILAS CONCEPT PLAN
DRAWN BY- Ar. SEHER SAIGAL			FOR - NAVOTHANAM
REVIEWED BY- ER. ANURAG			
SHEET NO -			

NOTE:  
THIS IS THE UNPUBLISHED WORK AND PROPERTY OF M/S SHRI DESIGN DESK, ENGINEERS & ARCHITECTS JABALPUR. THIS MAY NOT BE PUBLISHED, MISUSED, TEMPERED AND  
DUPLICATED WITHOUT THE WRITTEN CONSENT OF THE ARCHITECTS.

**SDPL**  
Shrikhande Design Pvt. Ltd.  
G-1, Ashokesh Apartment, Shanti Bridge, Naxos Tower,  
Jabalpur (M.P.) PIN- 482001 PH. NO. 0261-4038679  
Email - [office@sdplweb.com](mailto:office@sdplweb.com) Website - [www.sdplweb.com](http://www.sdplweb.com)

# NAVOTHANAM CONCEPT PLAN



# INFRASTRUCTURE COSTING AND TIME DURATION-

## 1st phase( 8 months)

	Projects	Proposed Measurement	B.U.A (sqft)	Approx. Cost(in Cr)
1	Villas	36 Nos	17430 @ 2100 to 2400	3.66 to 4.18
2	Main Building	1 Nos	11007@ 2100 to 2400	2.31 to 2.64
3	Mess & Dining	1 Nos	5326 @ 2500	1.33
4	Gate	1 Nos	L.S	0.25
5	Boundary Wall		5467@800sqft	0.50
6	Land Development(8 Acre)		2,00,000@150	3.00
7	Total Amount			11.05 to 11.90

# INFRASTRUCTURE COSTING AND TIME DURATION-

## 2nd phase - work in progress -

	Projects	Proposed Measurement	B.U.A (sqft)	Approx. Cost(in Cr)
1	Villa	85 Nos.		
2	Hall			
3	Activity Area			
4	OAT			
5	Covered Pool			
6	Staff Quarter			
7	Gardens			

# INFRASTRUCTURE COSTING AND TIME DURATION-

## 3rd phase - work in progress -

	Projects	Proposed Measurement	B.U.A (sqft)	Approx. Cost(in Cr)
1	<b>Villa</b>	80 Nos.		
2	<b>Workshop</b>			
3	<b>Guest Quarter</b>			
4	<b>Plazza</b>			
5	<b>Time office</b>			
6	<b>Remaining R&amp;D, Accessories</b>			
7	<b>Main Building F.F</b>			

# GALLERY



**NAVOTTHANAM**  
प्रेम ही संवेदना है।





**NAVOTTHANAM**  
प्रेम ही संवेदना है।

# THANK YOU

FOR YOUR ATTENTION

August 2024



+91 7987364219 / +91 74772 80103



Place Near phoenix poultry village Dunda, Khandiya  
tiraha, Barkheda Tehsil Kundam, Dist. Jabalpur M.P 483110



[info@navotthanam.org.in](mailto:info@navotthanam.org.in)



[www.navotthanam.org.in](http://www.navotthanam.org.in)

